



CHANCE VOUGHT F4U-5N CORSAIR

USN, HONDURAS & ARGENTINA
K072002

HISTORY

The Chance Vought F4U-5 Corsair was an evolution in the successful wartime Corsair family. It was fitted with the more powerful Pratt & Whitney R-2800-32W engine, redesigned cowl, cockpit and control surfaces and a powerful four 20mm cannon armament. The F4U-5 was fitted with AN/APS-6 or AN/APS-19 airborne intercept radar on the outer starboard wing.

The F4U-5N entered service with the US Marines too late for WWII but served in Korea. The cold conditions led to the development of the F4U-5NL with de-icing boots on the leading surfaces. Production continued until 1951 and they were exported to Argentina and Honduras. The Argentinian aircraft flew from the 'Independencia' [ex HMS & HMCS Warrior] until 1965 while the Honduran examples stayed in service long enough to fly in the 1969 "Soccer War" with El Salvador.

BEFORE YOU BEGIN

This kit has been produced using limited run moulding technology and multimedia components. A small amount of preparation is needed to get the best result.

- Wash the plastic parts with dishwashing liquid to remove the mould release residue
- The plastic parts have been moulded on a low pressure machine. Carefully remove the parts from the sprues and check the mating surfaces. These may need filing with a broad file or emery paper on a rigid surface to make a good surface.

To make this easier we have designed the gates so that they do not join where surface detail would be lost when filing or sanding.

- There is a slight chance some of the plastic parts may be warped. In this case, they can be adjusted by carefully warming the part with hot water. PLEASE USE CAUTION WHEN USING HOT WATER.

If the warping cannot be corrected please contact us for a replacement part.

COLOUR GUIDE

Colours on historic aircraft are often speculative. In such cases we give notes and sources for your information.

KEY	COLOUR	SPECIFICATIONS	APPROXIMATE MATCH						
			GUNZE MR COLOR	HUMBROL	MODELMASTER	REVELL	TAMIYA	XTRACOLOR	ALCLAD
A	INTERIOR GREEN	ANA 611	C351	151	1734	-	-	X117	
B	INSTRUMENT BLACK	ANA 514	H12	33	1749	36302	XF-01	X404	
C	LEATHER	-	H66	62	1736	62	XF-62	-	
D	ENGINE GREY	ANA 513	H339	32	1791	32167	XF-63	X128	
E	ZINC CHROMATE	-	352	81	4851	-	XF-4	X408	
F	SEA BLUE GLOSS	ANA 623	H55	-15	1917	-	XF-17	X121	
G	ALUMINIUM PAINT		H8	56	1781	32199	XF-16	-	ALC-101

PART LOCATION

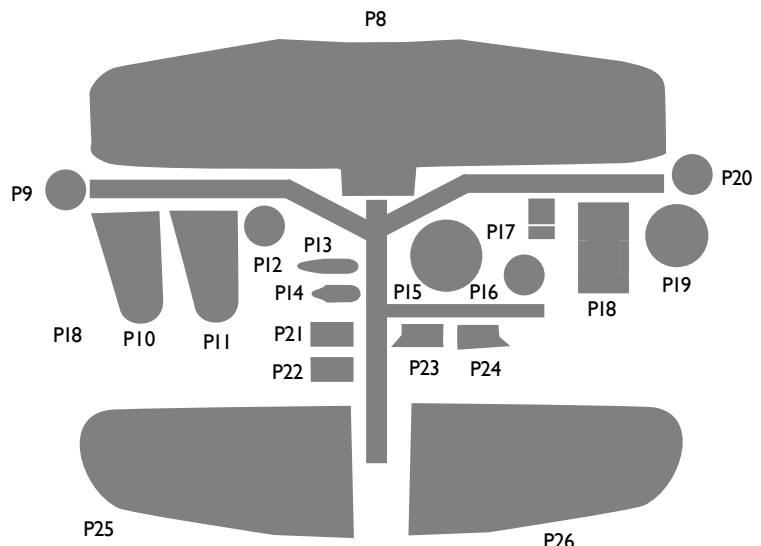
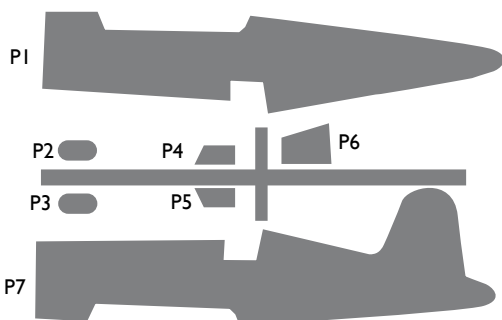

HPM Hobbies Pte Ltd © 2012

www.hpmhobbies.com

info@hpmhobbies.com

CONSTRUCTION

- P** INJECTION MOULDED PLASTIC **V** VACUUM FORMED PLASTIC **C** CAST METAL **S** SCRATCH BUILD
- R** POLYURETHANE RESIN **WARNING:** Polyurethane resin dust is toxic. A face mask should be worn and the residue carefully collected and disposed of following your local regulations.

STEP 1

Assemble the cockpit floor, seat, joystick and instrument panel.

Optional: add USN style belts to seat and reflector screen to gunsight

Colour Notes:

Cockpit floor and seat are ANA 611 Interior Green.

Instrument panels and side consoles to the floor are ANA 514 Instrument Black.

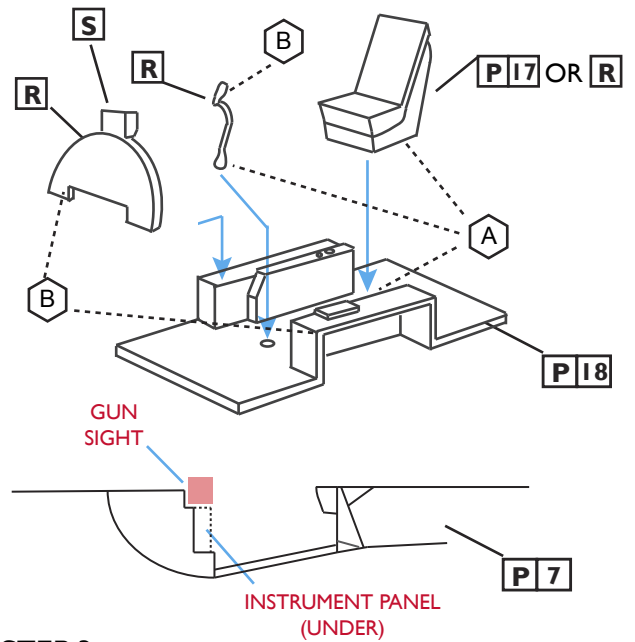

STEP 2

Test fit the cockpit in the fuselage sides.

Optional: Scratch build side wall detail and rear bulkhead. The coaming is quite busy with visible wiring behind the instruments and sight.

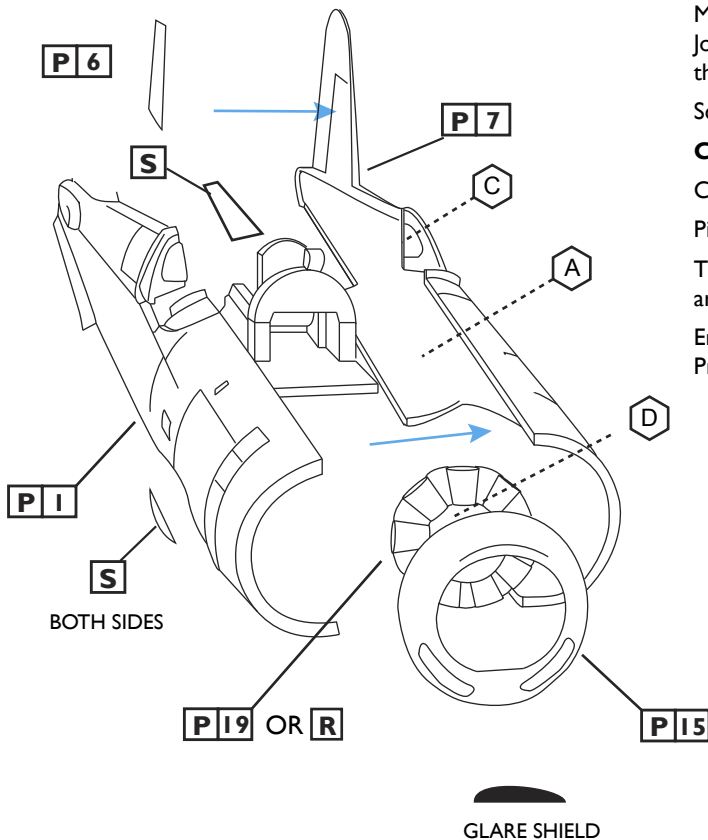

STEP 3

Make the rear wheel well from scratch using thick plastic card. Join the fuselage halves, including the cockpit and engine. Attach the cowl.

Scratch build glare shields for the cowl.

Colour Notes:

Cockpit sidewalls are ANA 611 Interior Green.

Pilot's headrest is leather.

The engine crankcase is ANA 513 Engine Grey and the pushrods are black.

Engine compartment and tail wheel well are Zinc Chromate Primer and the cowl rim matches the main camouflage colours.

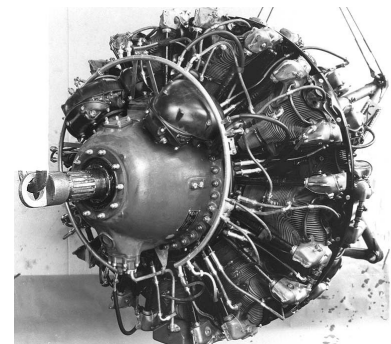

Photograph US Air Force

Drill a hole in the engine to accept the propellor shaft.

Note the alignment of the engine and propellor.

SCALE 1:72

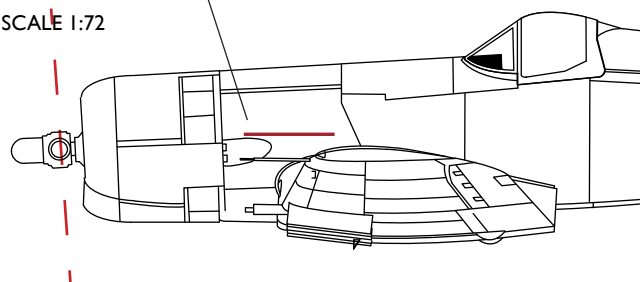

STEP 4

Thin the wing and check fit to fuselage.

Wing radiators fit inside the leading edge and will require adjustment for a good fit.

Cut slots in the tail and fit the tail planes.

Trim the canopy and fit with non-fogging glue.

Fit the propellor.

Colour Notes:

Cockpit coaming is black

Propellor is black with yellow tips and natural metal hub.

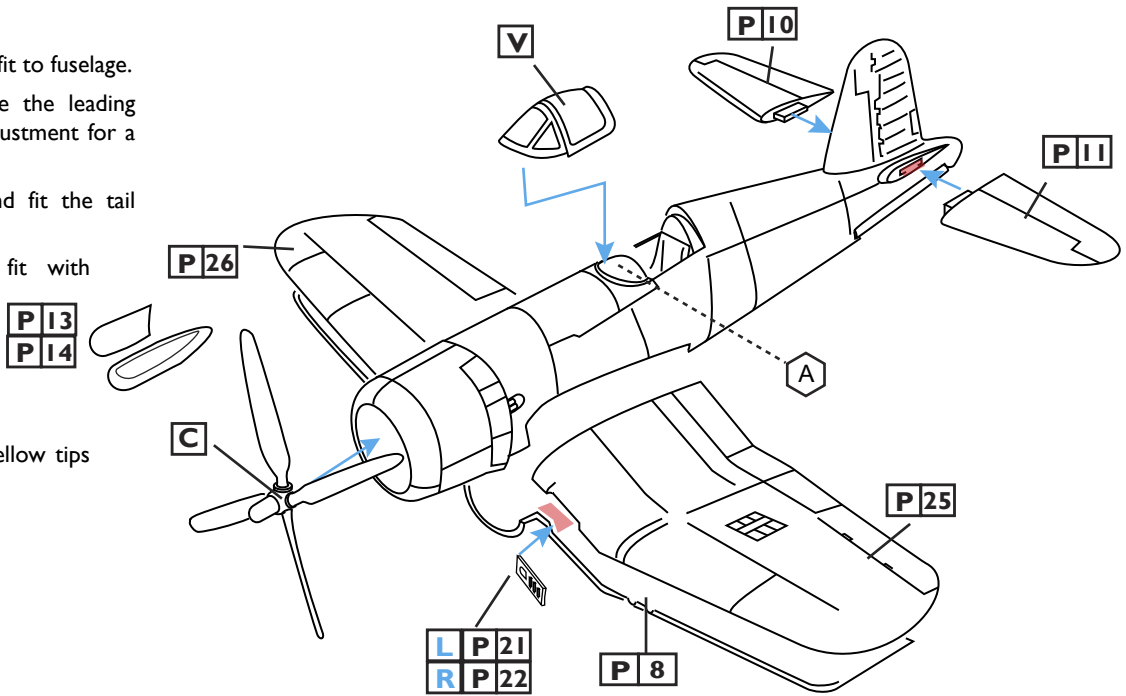

STEP 5

Drill locating holes for undercarriage legs and attach to wing. The legs are at 90° to the datum line in both axes.

For Honduran aircraft remove tail hook from tail wheel.

Drill a hole to accept the tail wheel post and attach. The front of the tail wheel assembly lines up with the front of the wheel well. Scratch build doors.

Attach the main undercarriage doors and wheels.

Colour Notes:

Main wheel wells are ANA 623 Sea Blue Gloss and undercarriage is aluminium paint. Some photos show aluminium door interiors.

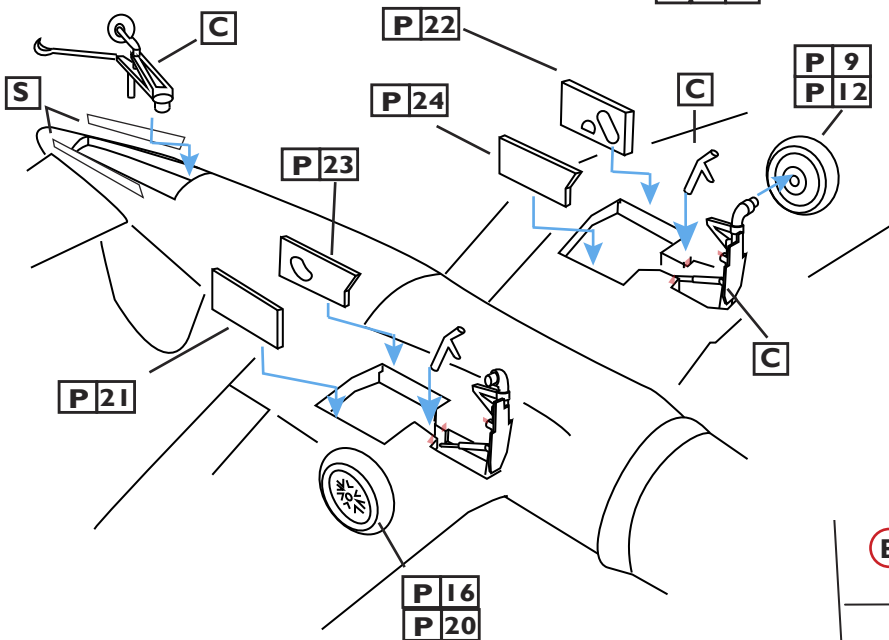

STEP 6

Attach the cannon barrels. The inboard canon extends 3.75 mm and the outboard canon extends 2.0 mm from the leading edge.

If desired, replace the barrels with flared tube.

Scratch build a pitot tube and aerials as required. Aerials have aerofoil cross section. Refer to marking diagrams for other fit out.

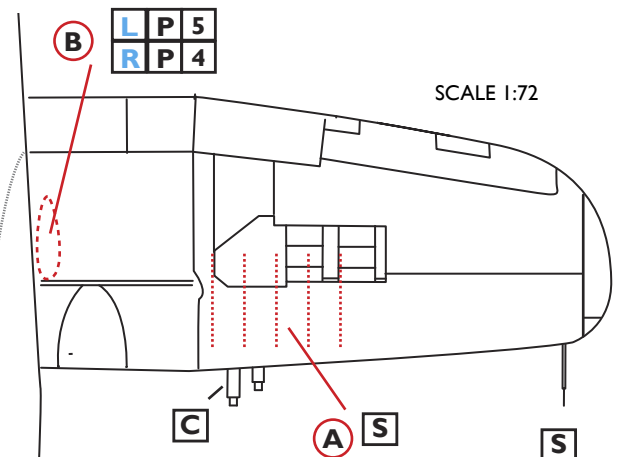
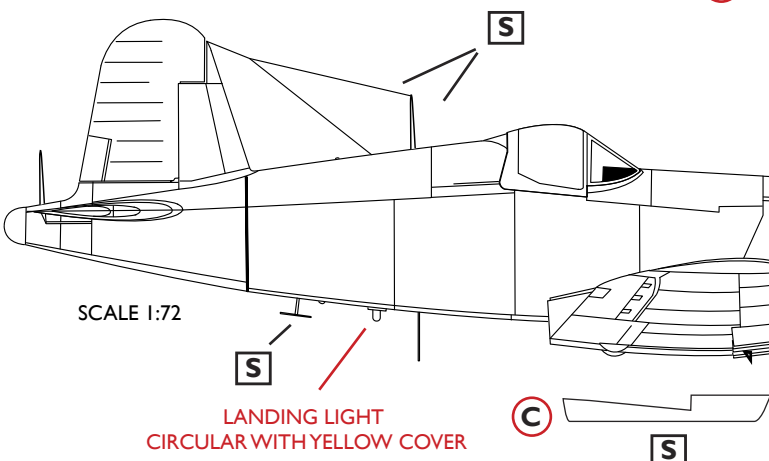

STORES

The aircraft was capable of three mount options:

- A** Aero-14 pylons: HVAR rockets
Bombs, napalm
- B** Inner wing pylons: Bombs, napalm
Tanks
- C** Central pylon: Bombs
Tanks

The open section of the central pylon aligns with the indentation on the lower fuselage.



F4U-5N BU 123176/WF 19

VMF(N)-513 US Marines

Korea, 1952

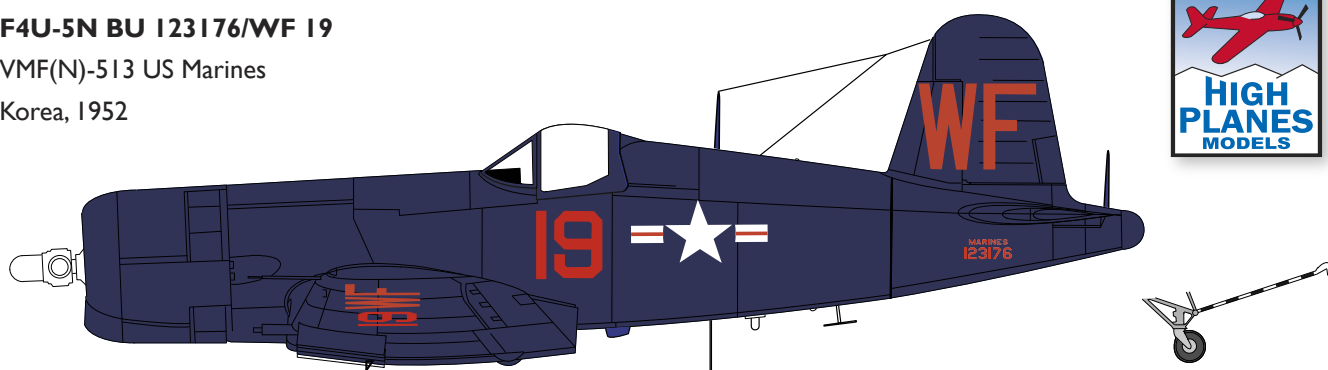

The F4U-5N aircraft of VMF-513 appear to have been painted matt black over the original sea blue. Wheels were either black or aluminium. Note the aerial configuration and period photographs of VMF-513 show the nightfighters were sometimes fitted with Aero-14 pylons and HVAR rockets.

We have also included the codes for WF 15, flown by Capt. Eugene Dickinson.

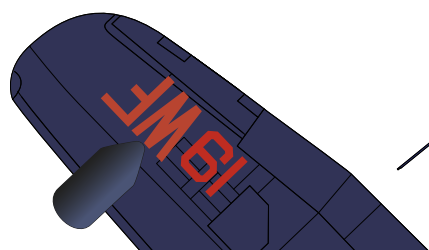

UPPER WING STARBOARD

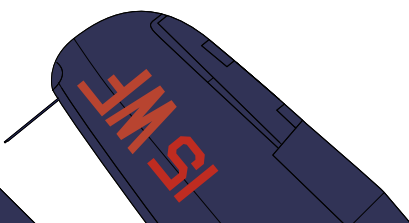

LOWER WING PORT

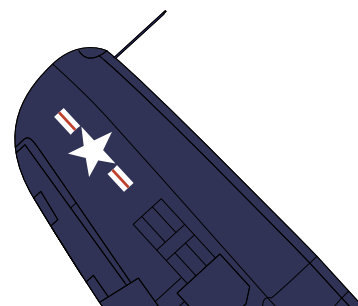

UPPER WING PORT

F4U-5N BU 124705/3-A-201

2da Escuadrilla Aeronaval de Caza y Ataque

Comando de Aviación Naval Argentina

1957

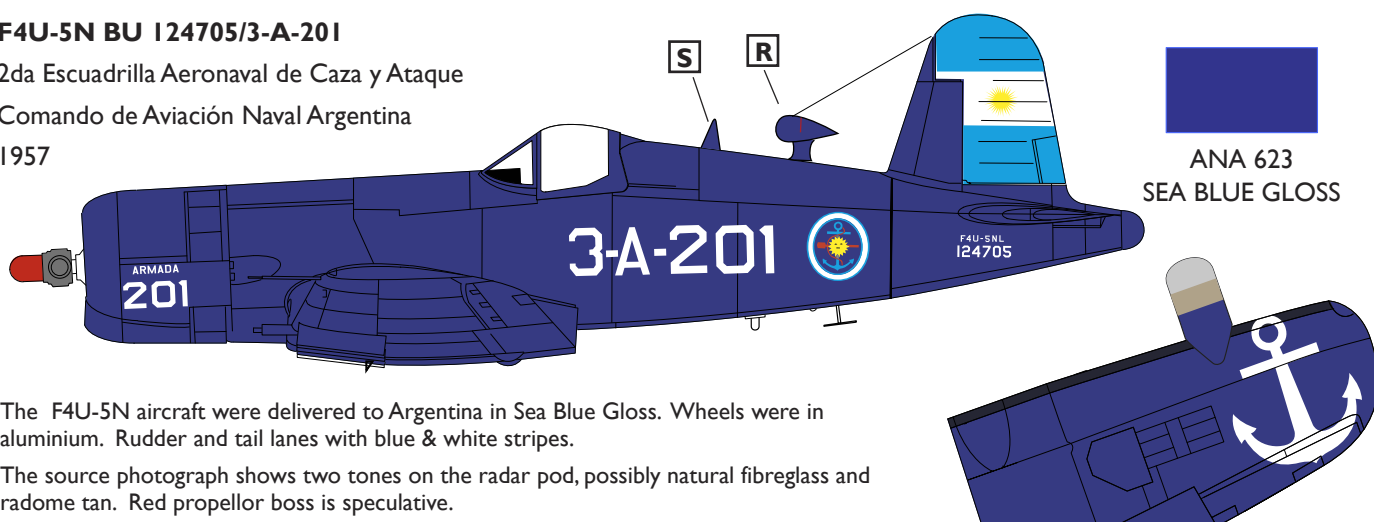

ANA 623
SEA BLUE GLOSS

The F4U-5N aircraft were delivered to Argentina in Sea Blue Gloss. Wheels were in aluminium. Rudder and tail lanes with blue & white stripes.

The source photograph shows two tones on the radar pod, possibly natural fibreglass and radome tan. Red propellor boss is speculative.

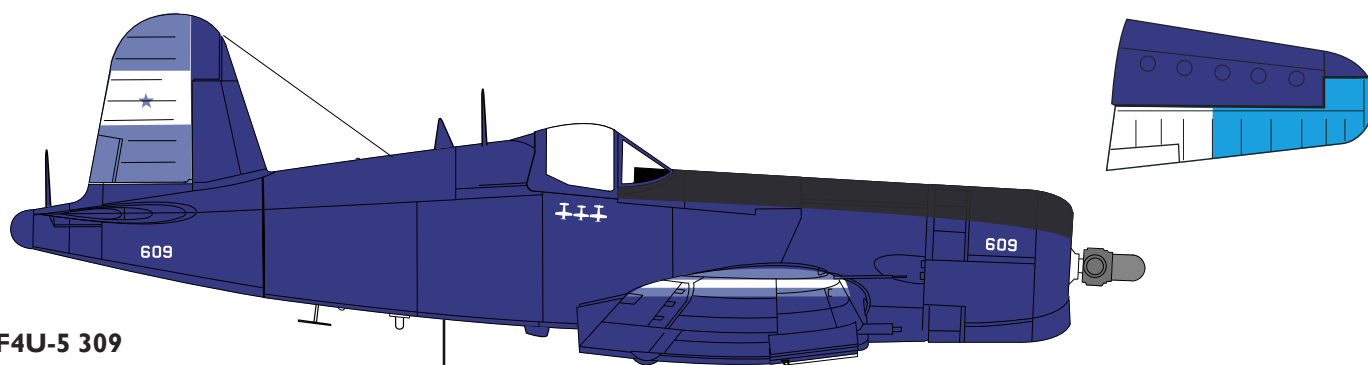

F4U-5 309

Fuerza Aerea Hondurena

Honduras, 1969 "Soccer War"

The Honduran F4U-5N had the wing radar pod removed. Wheels are Sea Blue. The aircraft were very worn with a matt surface finish.

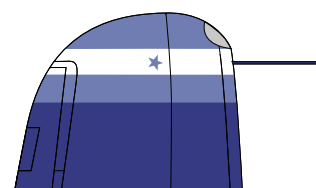

REFERENCES

Modellers Data File 18: Vought F4U Corsair, Morrisey & Hegedus, SAM Publications 2010.

Aircam Aviation 23: Vought F4U-7 Corsair in USMC, USN, FAA, Aeronavale, & Foreign Service, Arco Publishing 1971